

THIS COPY IS PROVIDED ON A RESTRICTED BASIS AND IS NOT TO BE USED IN ANY WAY DETRIMENTAL TO THE INTERESTS OF PANDUIT CORP.

PANDUIT PART #	WIRE RANGE		DIMENSIONS in. [mm]				
	AWG	[mm <sup>2</sup> ]	L ± .02 [0.5]	W ± .02 [0.5]	H ± .02 [0.5]	C ± .02 [0.4]	D ± .01 [.3]
EQSP14D	#18-14	0.75-2.5	.76 [19.4]	.51 [13.0]	.30 [7.6]	.35 [8.8]	.03 [.7]

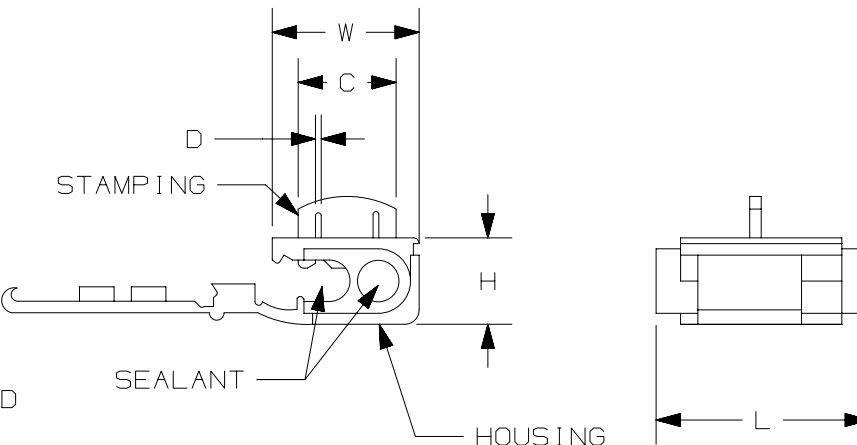

NOTES:

- USED FOR:
  - STRANDED COPPER WIRE ONLY
  - CONTAINS MOISTURE RESISTANT SEALANT
  - 221°F [105°C] MAX. OPERATING TEMPERATURE
  - 600 V. MAX VOLTAGE RATING
- MATERIAL:
  - STAMPING: 0.31" [.8] THICK BRASS, TIN PLATED
  - HOUSING: POLYPROPYLENE, BLUE
  - SEALANT: SILICONE
- SEE [www.panduit.com](http://www.panduit.com) FOR PACKAGE QUANTITIES
- DIMENSIONS IN BRACKETS ARE METRIC EQUIVALENT

B

B



A

A

D110100DA/15

00	2/18	JHNU	TMR	RGB	DRAWING RELEASED			00123SS	
REV	DATE	BY	CHK	APR	DESCRIPTION	ECN			

<b>TITLE</b> STRONGHOLD QUICK SPLICE CONNECTOR IDC WITH MOISTURE RESISTANT SEALANT #18-14 AWG CUSTOMER DRAWING					
<b>ITEM REVISION NAME</b> 00123SSJ/00					
<b>DATASET FILE NAME</b> 00123SSJ/00					
UNLESS OTHERWISE SPECIFIED, DIMENSIONAL TOLERANCES ARE: IN [mm]		<b>MATERIAL:</b>  SEE NOTES			
.x ± .1 [2.54]      .xxx ± .005 [.127] .xx ± .01 [.25]      ANGLES ± 5°					
		<b>DRAWING NUMBER:</b> 00123SSJ-DC			
<b>DRAWN BY</b> JHNU	<b>DATE</b> -		<b>CHK</b> -	<b>SCALE</b> N.T.S.	<b>SHT 1 OF 1</b>